

ALARM AND SECURITY

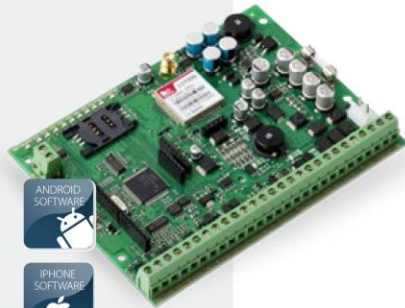

ESIM264

GSM SMART HOME 44 ZONES CONTROL PANEL

ESIM264 is an Alarm and Control Panel for securing premises and controlling electronic devices or managing building automation through the GSM network. The panel can work as a personal alarm system informing only authorised users via SMS/ CALL or it can communicate with a monitoring station.

COMPLIES WITH EN 50131-1 GRADE 2 CLASS II

APPLICATIONS

- Security of premises
- Control of electrical devices by SMS text
- Temperature measurement and control
- Electric power network failure control
- Wireless intercom
- Tank level or other 0-30V Voltage sensor measurement (optional extra)

FEATURES

- Arm/disarm by free of charge call, keypad, iButton, wireless keyfob or any input
- Built-in Quad-Band GSM/GPRS communicator
- SMS and/or CALLS to 5 authorised users
- CONTACT ID for monitoring station through GSM voice or GPRS
- Easily transformable to 868MHz wireless alarm panel
- Temperature measurement and alarm when the controlled temperature exceeds the allowed limits
- STAY feature
- Intercom extension module
- 4 ways of configuration: SMS, Keypad, USB or Internet
- Event Log access by Internet
- Compatible with EGR100 monitoring station software



METAL ENCLOSURE ME1 FOR ESIM264/364

- Transformer included
- Transformer type TSZZB 40/002M/3
- Transformer input 230V AC
- Transformer output 17V-2,35A
- Fuse 1A
- Tamper switch

TECHNICAL SPECIFICATIONS

Partitions **2**
On-board zones **6 (12 ATZ mode)**
PGM outputs **4, possibility to increase to 44**
Wireless **Optional extra**
Expandable wireless devices: (zones, PGM, key fobs, etc.) **16**
Keypads **4**
Keypad zone support **yes**
User codes **30**
Dallas key iButton reader **yes**
On-board programmable outputs **4x500mA**
Event buffer **100**
Event Log **500**
Built in GSM/GPRS module **900/850/1800/1900 MHz**
Ways of event communication **Ademco Contact ID, SMS, Voice Calls, GPRS,**
Authorized users **5**
Digital temperature sensor **DS18S20, DS18B20**
Microphone **yes**
Audio OUT **optional**
Dimensions **140x100x18mm**

ESIM364

GSM 76 ZONES WIRELESS CONTROL PANEL

ESIM364 is a multi-functional hybrid alarm and control panel with built-in GSM & Wireless modules on board. The system can be upgraded with PSTN and/or Ethernet based communicator for operation in IP based network.

COMPLIES WITH EN 50131-1 GRADE 3 CLASS II

FEATURES

- Compatible with ELDES Smart Security. Android and IOs apps
- Convenient system configuration via:
- GPRS, SMS, Keypad, USB or IP network (optional)
- Remote configuration does not require Static IP address
- Multiple Arm/disarm methods: Free of charge call, SMS, keypad, key-fob, Dallas key
- Contact ID to monitoring station via GSM Voice, GPRS, PSTN, IP network (optional)
- Remote real time diagnostics via GPRS/IP
- Remote firmware upgrade
- SMS, Calls, Voice messages to 10 authorized users
- PGM output control by event and/or scheduler
- Supports up to 16 separate logic schedulers

TECHNICAL SPECIFICATIONS

Partitions **4**
On-board zones **6 (12 ATZ mode)**
Expandable zones **up to 76**
Wireless **868MHz integrated**
PGM outputs **4 , possibility to increase to 76**
Keypads **4**
Keypad zone support **yes**
User codes **30**
Dallas key iButton reader **yes**
On-board programmable outputs **4x500mA**
Event buffer **100**
Event Log **500**
Built in GSM/GPRS module **900/850/1800/1900 MHz**
Ways of event communication **Ademco Contact ID, SMS, Voice Calls, GPRS, PSTN optional, Ethernet (optional)**
Authorized users **10**
Digital temperature sensor **DS18S20, DS18B20**
Number of temperature sensors **8**
Wireless keyboard EKB3W support **yes**
Voice Messages **yes**
Microphone **yes**
Audio OUT **optional**
Dimensions **140x100x18mm**

ALARM AND SECURITY



APPLICATIONS

- Securing property
- Building automation
- Remote management of electronic appliances
- Telemetry

METAL ENCLOSURE ME1 FOR ESIM264/364



- Transformer included
- Transformer type TSZZB 40/002M/3
- Transformer input 230V AC
- Transformer output 17V-2,35A
- Fuse 1A
- Tamper switch

I/O ETHERNET CONTROLLER ELAN3 FOR ESIM364



Enables internet access through LAN interface

ALARM AND SECURITY



COMPATIBLE
WITH ELDES
SMART
SECURITY



SIM card and backup
battery inside



STARTING SECURITY
SYSTEM EPIR2
OPERATION IS AS SIMPLE
AS MOBILE PHONE:

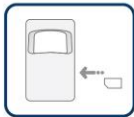

Insert SIM card



Connect to mains power socket



The system is ready to work

EPIR2

STANDALONE GSM ALARM SYSTEM

EPIR2 is a complete security system with GSM integrated in one very compact and easy to use device. Control panel, motion detector, wireless and GSM module systems all in one product. EPIR2 will immediately alert about security breach via SMS or call.

FEATURES

- Self-install system
- Arm/disarm by free of charge call, keyfob or EKB3W keypad
- Built-in Quad-Band GSM/GPRS communicator
- SMS and/or CALLS to 10 authorised users
- CONTACT ID for monitoring station through GSM voice or GPRS
- Integrated 868 MHz ELDES WIRELESS
- Built in microphone and backup battery
- 4 ways of configuration: SMS, USB, Internet or keypad
- Event Log access by Internet

APPLICATIONS

- Apartments
- Summer houses
- Garages
- Small shops
- Campers
- Boats

TECHNICAL SPECIFICATIONS

On-board zones **1 digital infrared PIR sensor zone and 1 wired zone**

Expandable zones **up to 34**

Expandable programmable outputs **up to 32**

Wireless **868 MHz integrated**

Expandable wireless devices: (zones, PGM, key fobs, etc.) **16**

Event Buffer **100**

Built in GSM/GPRS module **850/900/1800/1900 MHz**

Ways of event communication **Ademco Contact ID, SMS, Voice Calls, GPRS**

Authorized users **10**

Microphone **yes**

Backup battery **Yes, built-in**

Detection angle and range **90° up to 10 m**

Outputs **1 for siren connection or event indication**

Dimensions **104x60x33mm**

EPIR3

STANDALONE GSM ALARM SYSTEM

EPIR3 is a standalone, portable security system designed for both end users and professionals, suitable for protection of residential and business properties. The system is compact and user friendly, therefore can be easily installed in less than 5 minutes. Furthermore, the system supports Contact ID protocol, making the EPIR3 compatible with global security protocol standard, allowing output to any monitoring station. One of a kind security control panel with motion detector, wireless and GSM modules in one piece has made security simple!

FEATURES

- 1 built-in PIR sensor zone and one wired
- Pet immune
- Portable
- Compact
- Built-in GSM/GPRS communicator
- Expandable (Integrated Eldes Wireless interface)
- Easy configuration (USB, Internet or SMS)
- Back up battery
- Covert listening
- Powerloss identification and reporting

APPLICATIONS

- Apartments
- Summer houses
- Garages
- Small shops
- Campers
- Boats

TECHNICAL SPECIFICATIONS

On-board outputs **1 wired for siren connection or event indication via LED**
Expandable zones **up to 34**
Expandable programmable outputs **up to 32**
Wireless **868 MHz integrated**
Expandable wireless devices: (zones, PGM, key fobs, etc.) **16**
Event Buffer **100**
Built in GSM/GPRS module **850/900/1800/1900 MHz**
GSM antenna type **internal**
Ways of event communication **Ademco Contact ID, SMS, Voice Calls, GPRS**
Authorized users **10**
Backup battery **Yes, built-in**
Detection angle and range **90° up to 10 m**
Backup battery **Ni-Mh, up to 24 hours**
Dimensions **120x65x60mm**

ALARM AND SECURITY



SIM card and backup battery inside



3 STEPS EPIR3 SYSTEM OPERATION

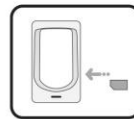

Insert SIM card

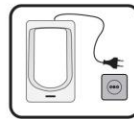

Connect to mains power socket



The system is ready to work